



LOCATION PLAN 1 : 2500

-Architect:	Jones Sonter
-Town Planning Consultant:	Andrew Robinson Planning
-Stormwater Engineer:	Australian Consulting Engineers
-Landscape Architect:	Zenith Landscapes
-Heritage Consultant:	NBRS & Partners
-Traffic Consultant:	Varga Traffic Planning
-BASIX Consultant:	Basixmax
-Photomontage	Integrated Design Solutions

Woodville St Retail/Residential

13-17 Woodville Street, Hurstville

Issued for Revised Development Application: 20.12.2010

ARCHITECTURAL DRAWINGS

DA0.00 Cover & Location Plan
DA0.01 Cover Sheet & Location Plan

DA1.00 Site Context
DA1.01 Site Context Plan
DA1.02 Site Analysis Plan

DA2.00 Floor Plans
DA2.01 Basement Level 3 Plan
DA2.02 Basement Level 2 Plan
DA2.03 Basement Level 1 Plan
DA2.04 Ground Level Plan
DA2.05 Podium Level Plan
DA2.06 Level 2 Plan
DA2.07 Levels 3 & 5 Plan
DA2.08 Levels 4 & 6 Plan
DA2.09 Level 7 Plan
DA2.10 Level 8 Plan
DA2.11 Level 9 Plan

DA3.00 Sections
DA3.01 Sections A
DA3.02 Sections B
DA3.02 Sections C

DA4.00 Elevations
DA4.01 Northwestern Elevation
DA4.02 Southeastern Elevation
DA4.03 Northeastern Elevation
DA4.04 Southwestern Elevation

DA5.00 Diagrams
DA5.01 Shadow Diagrams - Summer Solstice
DA5.02 Shadow Diagrams - Winter Solstice

DA6.00 Miscellaneous
DA6.01 GFA Calculations
DA6.02 Driveway Profile



Suite 2 Level 1
505 Balmain Rd
Lilyfield NSW
PO Box 483
Rozelle NSW 2039
phone: 02 9555 7464
fax: 02 9555 7436
mail@jonesonter.com.au

Drawing No.
DA0.01

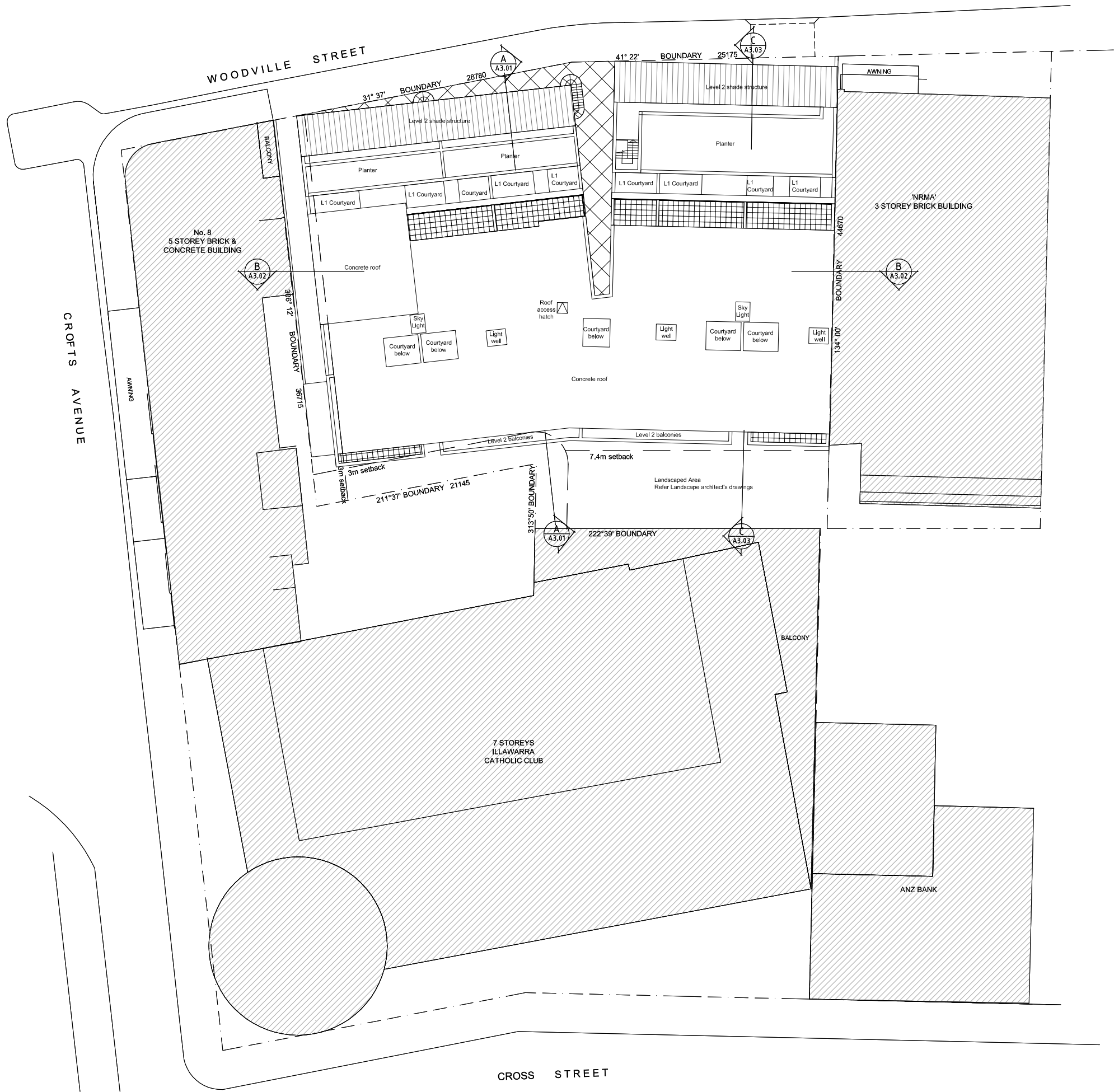

Basix Certificate No. 330276M	
Water Specifications:	
Showerheads & all WCs:	min 3.0 stars
Bathroom & Kitchen taps:	min 4.0 stars
Rainwater tank:	total 10,000L tank
Roof area to be diverted to tank:	850 sqm
Energy Specifications:	
Central hot water system:	Gas instantaneous 4 star
Ventilation systems - bathrooms, kitchens & laundries:	Individual fan, ducted to facade or roof - manual switch on/off
Carpark ventilation:	supply & exhaust - carbon monoxide monitor & VSD fan
Kitchen cooktops/oven:	Gas cooktop/electric oven
Common area lighting:	compact fluorescent with daylight sensors to all areas excl. Garbage Rm. Motion sensors to carparks. Manual on/manual off switch to Garbage Rm

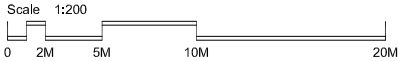

© JONES SONTERR. ALL RIGHTS RESERVED. THIS WORK IS COPYRIGHTED AND CANNOT BE REPRODUCED OR COPIED IN ANY FORM OR BY ANY MEANS WITHOUT THE WRITTEN PERMISSION OF JONES SONTERR. ANY LICENSE TO USE THIS DOCUMENT, WHETHER EXPRESSED OR IMPLIED, IS RESTRICTED TO THE TERMS OF THE AGREEMENT OR IMPLIED AGREEMENT BETWEEN JONES SONTERR AND THE INSTRUCTING PARTY.
ALL DIMENSIONS IN MILLIMETRES UNLESS OTHERWISE SHOWN. USE FIGURED DIMENSIONS ONLY.
DO NOT SCALE FROM DRAWINGS.
CHECK ALL DIMENSIONS ON SITE PRIOR TO CONSTRUCTION. REPORT ANY DISCREPANCIES TO JONES SONTERR.
TO BE READ IN CONJUNCTION WITH ALL OTHER DOCUMENTS.
NSW ARCHITECTS REGISTRATION BOARD REGISTERED ARCHITECTS:
NSW JONES Registration No. 6460
BRAD SONTERR Registration No. 6467

Rev.	Revision Description	Chk.	Appr.	Date
1	Issued for Information			06-08-10
2	Issued for Information			13-08-10
3	Issued for Information			20-08-10
4	Issued for information			30-08-10
DA	DA Submission			07-09-10
DA1	L & E Court Submission			06-12-10
DA2	Revised DA Submission			20-12-10

Rev.	Revision Description	Chk.	Appr.	Date

Project
Retail / Residential Development
13-17 Woodville Street, Hurstville

JONES SONTERR
Suite 2 Level 1
505 Balmaln Rd
Lllyvfield NSW
PO Box 483
Rozelle NSW 2039
phone: 02 9555 7464
fax: 02 9555 7436
mail@jonesonter.com.au
www.jonesonter.com.au

Title
Site/Roof Plan

Scales 1:200 at A1	Date July 2010	Drawn EJ, WE, JY
Project No. 100403	Checked Approved	Revision DA2
Drawing No. DA1.01		
Plot Date 20-12-10		Cad Ref. J:\100401\Docs\Cad\DA1\01

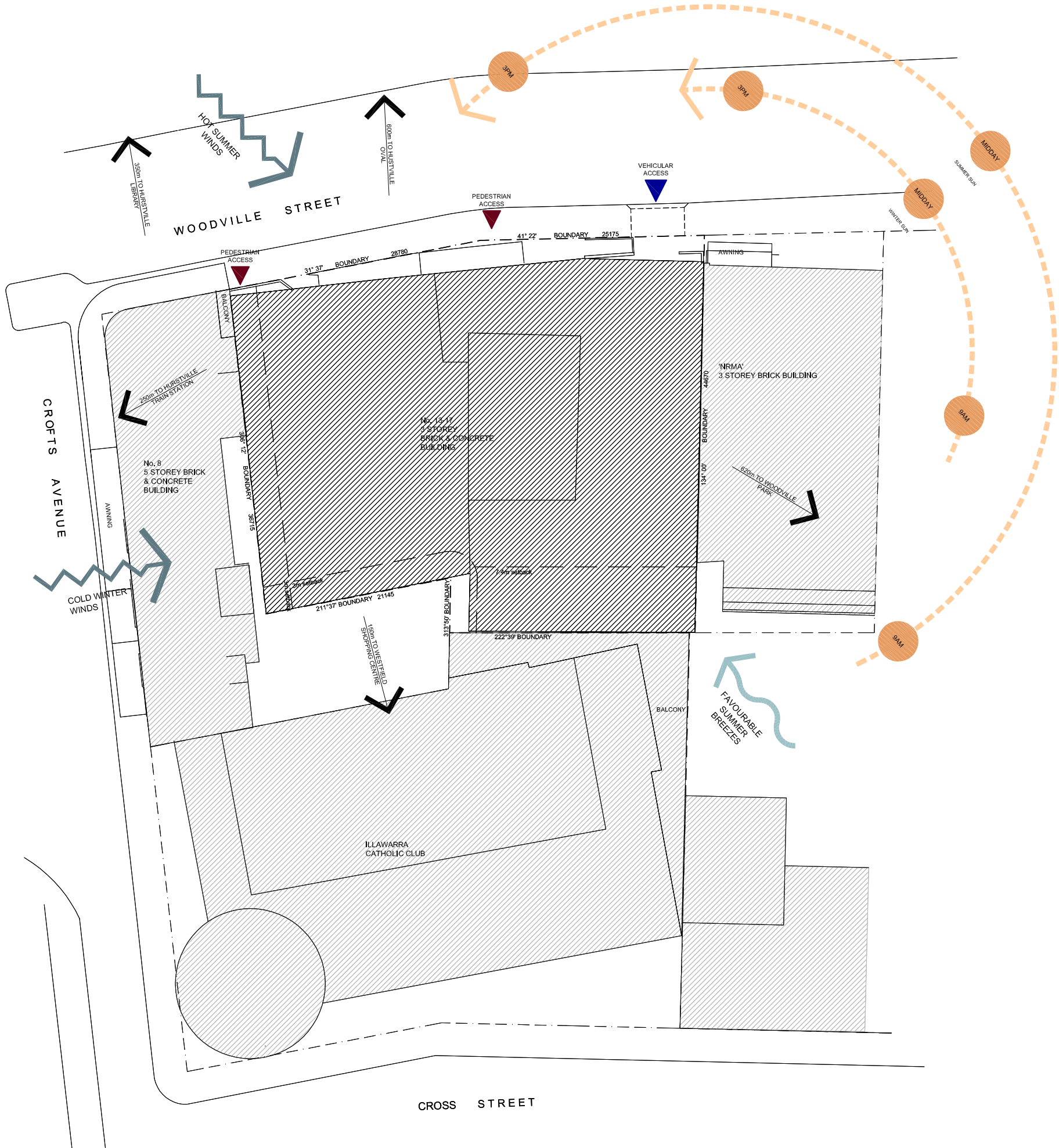

Basix Certificate No. 330276M	
Water Specifications:	
Showerheads & all WCs:	min 3.0 stars
Bathroom & Kitchen taps:	min 4.0 stars
Rainwater tank:	total 10,000L tank
Roof area to be diverted to tank:	850 sqm
Energy Specifications:	
Central hot water system:	Gas instantaneous 4 star
Ventilation systems - bathrooms, kitchens & laundries:	Individual fan, ducted to facade or roof - manual switch on/off
Carpark ventilation:	supply & exhaust - carbon monoxide monitor & VSD fan
Kitchen cooktops/oven:	Gas cooktop/electric oven
Common area lighting:	compact fluorescent with daylight sensors to all areas excl. Garbage Rm. Motion sensors to carpark. Manual on/manual off switch to Garbage Rm

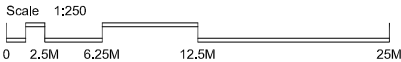

© JONES SONTERR. ALL RIGHTS RESERVED. THIS WORK IS COPYRIGHTED AND CANNOT BE REPRODUCED OR COPIED IN ANY FORM OR BY ANY MEANS WITHOUT THE WRITTEN PERMISSION OF JONES SONTERR. ANY LICENSE TO USE THIS DOCUMENT, WHETHER EXPRESSED OR IMPLIED, IS RESTRICTED TO THE TERMS OF THE AGREEMENT OR IMPLIED AGREEMENT BETWEEN JONES SONTERR AND THE INSTRUCTING PARTY.
ALL DIMENSIONS IN MILLIMETRES UNLESS OTHERWISE SHOWN. USE FIGURED DIMENSIONS ONLY.
DO NOT SCALE FROM DRAWINGS.
CHECK ALL DIMENSIONS ON SITE PRIOR TO CONSTRUCTION. REPORT ANY DISCREPANCIES TO JONES SONTERR.
TO BE READ IN CONJUNCTION WITH ALL OTHER DOCUMENTS.
NEW ARCHITECTS REGISTRATION BOARD REGISTERED ARCHITECTS:
KIM JONES Registration No. 6460
BRAD SONTERR Registration No. 6467

Rev.	Revision Description	Chk.	Appr.	Date	Rev.	Revision Description	Chk.	Appr.	Date
1	Issued for Information			20-08-10					
2	Issued for Information			30-08-10					
DA	DA Submission			07-09-10					
DA1	L & E Court Submission			06-12-10					
DA2	Revised DA Submission			20-12-10					

Project	Retail / Residential Development
	13-17 Woodville Street, Hurstville

JONES SONTERR
Suite 2 Level 1
505 Balmain Rd
Lilyfield NSW
PO Box 483
Rozelle NSW 2039
phone: 02 9555 7464
fax: 02 9555 7436
mail@jonesonterr.com.au



Title	Site Analysis Plan
-------	--------------------

Scales	1:250 at A1	Date	July 2010	Drawn	ERF
Project No.	100403	Checked		Approved	
Drawing No.	DA1.02	Revision	DA2		
Plot Date	17-12-10	Cad Ref.	J:\100401\Docs\Cad\DA1.02		

13-17 Woodville St, Hurstville